

Combined pumps should be mounted in decreasing order of absorbed power, paying attention to the maximum acceptable torques (see diagram below). The ordering code for a combined pump should be specified according to coupling sequence (primary pump code + coupling unit code + secondary pump code).

- The sum of individual torques of all pumps in the complete pump combination must not exceed the maximum permissible torque value applicable to the primary pump shaft ( $T_{max}$  see page 4).
- Secondary pump torque (or sum of torques for more than one secondary pump) must not exceed the coupling unit maximum thru drive torque ( $T_a$ , see table below).

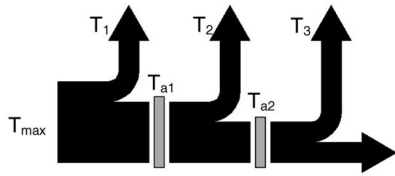

$$\begin{cases} T_1 + T_2 + T_3 < T_{max} \\ T_2 + T_3 < T_{a1} \\ T_3 < T_{a2} \end{cases}$$

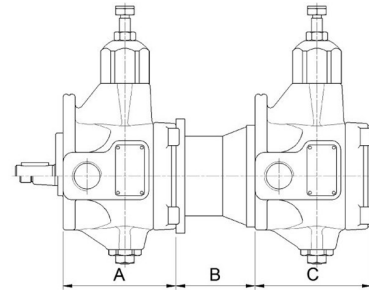

PRIMARY PUMP		SECONDARY PUMP		COUPLING UNIT		Maximum thru drive torque $T_a$			
Pump type	A	Pump type	C	Code	B				
01 PLP 05 16 F..A	104	01 PLP 05 16 F	107	3000010200	73	55 Nm			
		01 PLP 05 16 FGR2	107	3000011200	72				
		01 PHP 05 16 F	145	3000010200	73				
		01 PHP 05 16 FGR2	145	3000011200	72				
		SAE "A"	(*)	3100000100	88.5				
		GEAR PUMP .1P	(**)	3000011000	64				
		GEAR PUMP 1	(**)	3000011100	64				
01 PLP 1 (20-25-32) F..A	163	01 PLP 05 16 F	107	3000010200	73				
		01 PLP 05 16 FGR2	107	3000011200	72				
		01 PHP 05 16 F	145	3000010200	73				
		01 PHP 05 16 FGR2	145	3000011200	72				
		SAE "A"	(*)	3100000100	88.5				
		GEAR PUMP 1P	(**)	3000011000	64				
		GEAR PUMP 1	(**)	3000011100	64				
01 PLP 2 (40-50-63) F..A 01 PLP 3 (80-100-120) F..A	199.5	GEAR PUMP 2	(**)	3000011200	72	110 Nm			
		GEAR PUMP 3	(**)	3000022300	91				
		01 PLP 05 16 F	107	3000020400	85				
		01 PLP 05 16 FGR2	107	3000022200	90				
		01 PHP 05 16 F	145	3000020400	85				
		01 PHP 05 16 FGR2	145	3000022200	90				
		01 PLP 1 (20-25-32) F	166	3000020100	87				
	237	01 PHP 1 (20-25-32)F	166	3000020100	87				
		01 PLP 2 (40-50-63)F	202.5	3000020200	102				
		01 PHP 2 (40-50-63)F	202.5	3000020200	102				
		SAE "A"	(*)	3100000200	100,5				
		SAE "B"	(*)	3100000300	126,5				
		01 PLP 3 (80-100-120) F..A	237	01 PLP 3 (80-100-120) F	240		3000020300	117	180 Nm
				01 PHP 3 (80-100-120) F	240		3000020300	117	

(\*) For the secondary pump SAE A flange dimensions please see page 16.  
In order to find out the secondary SAE flange pump axial dimension please see the manufacturer's catalogue.

(\*\*) For the secondary gear pump flange dimensions please see page 16.  
In order find out the secondary gear pump axial dimension please see the manufacturer's catalogue.

For other coupling unit types, please contact Berarma Technical-Sales Service.